

Synergii



ARCISAN

Synergii



The Synergii range has been conceptualised and designed in Australia to best suit your needs. The Synergii collection is a new radical approach to product design, which combines the geometric with the organic. The success of the design is in its ability to merge flat surfaces into flowing, rounded forms as well as incorporating the latest technologies in sanitaryware. By embracing technology, we're able to deliver a toilet that is quite possibly the most comfortable and easy to clean you can buy.

Synergii toilets are available in three different options; back-to-wall suite, wall-faced pan and wall-hung pan so there is an option to suit any style of home.



technologies



Rimless technology

The Synergii toilet features the latest technology in rimless flushing. By incorporating rimless flushing technology the entire bowl is cleaned thoroughly because there are no impediments to the water flow; therefore the flush is more forceful. The pan is more hygienic by having no rim for the dirt or bacteria to hide under and hand cleaning the bowl becomes that much easier as there are no lips to deal with.





Ergonomic seat

The slimline seat from Haro of Germany has been designed with comfort first and foremost in mind; it is quite possibly the most comfortable toilet seat you can buy. Its soft close system has been tested for 50,000 push/pull cycles and boasts the longest warranty of any available. It also features the patented “Take Off” hinges for quick and easy one-handed removal, without the use of buttons. The hinges are also fixed point to guard against them coming loose over time.



“
By embracing technology, we’re able to deliver a toilet that decreases your cleaning time in the bathroom.
”



Comfort height

The Synergii toilet suite and wall-faced pan strike the perfect balance between aesthetics and function. Both pans are considered ‘comfort height’, which makes it easier to get on and off the toilet suite.

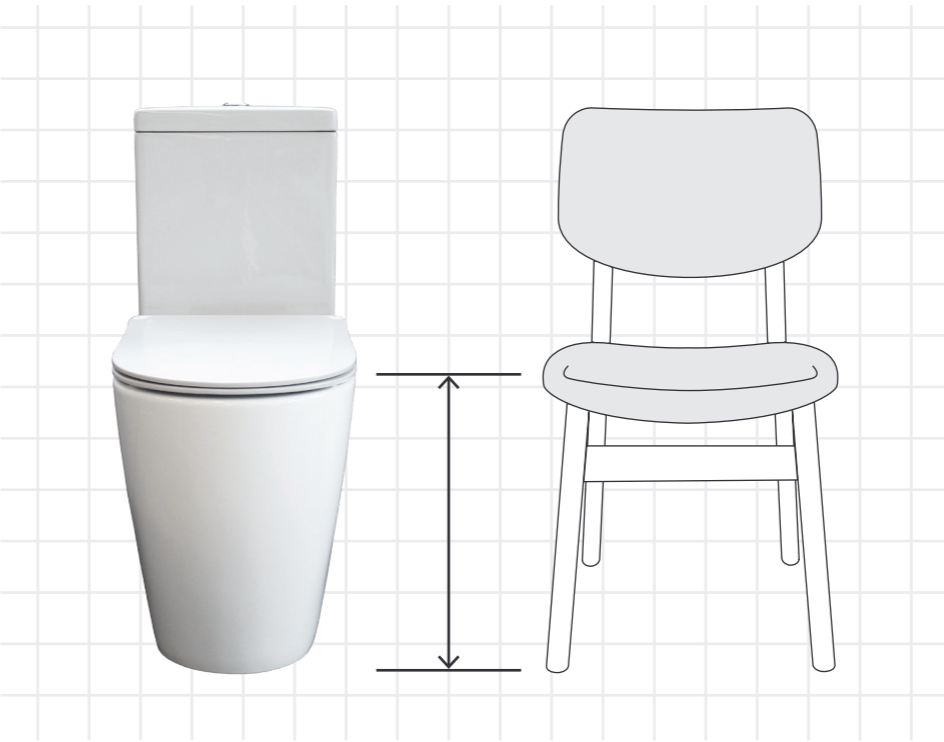



CleanTect

The Synergii toilet has been engineered to be easy to clean. The ceramic surface in the bowl has a special glaze incorporating nano-technology. Called ‘CleanTect’, this special glaze enables your pan stay cleaner for longer by giving the ceramic a smoother surface at a microscopic level. By having a smoother surface and a better, less restrictive flushing system; all adds up to a superior clean flush after flush. An added bonus to this technology is the reduced amount of chemical cleaners needed, which ultimately is better for our environment.

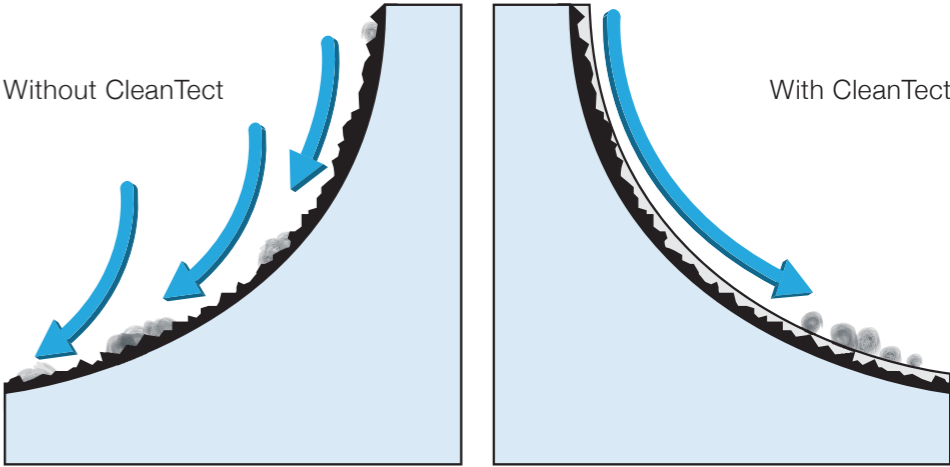

10 Warranty

Arcisan sanitaryware is made to the highest standards and crafted from the finest material. Thus, the chinaware is covered by a 10 year warranty against manufacturing defects*. In addition, the soft close seat mechanism is also guaranteed for 10 years.



Reliability

To ensure a long trouble free life, the Synergii toilet suite features flush mechanisms from the world’s market leader, Swiss based Geberit. Exceptionally reliable and strong, the mechanisms also have a 25 year spare part supply guarantee.

* Subject to terms and conditions.



“
The Synergii range
strikes the perfect
balance between
aesthetics
and function.
”



tech specs



Toilet suite with slim line seat
SY04117 - Back Inlet
SY04118 - Dual Inlet
WELS 4 stars | 4.5 / 3L
S-trap 80 - 200mm
P-trap 185mm
[Icons: Flush, Dual Inlet, S-trap, P-trap, WELS 4 stars]

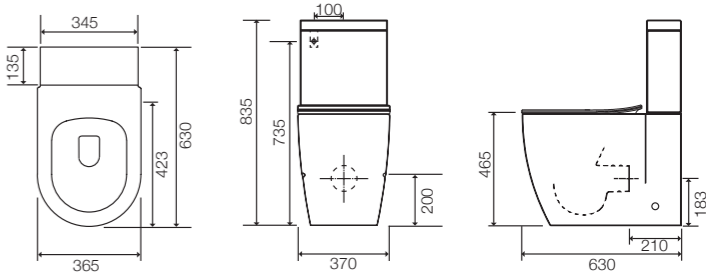

Wall faced pan
with slim line seat
SY04152
WELS 4 stars | 4.5 / 3L
S-trap 90mm
P-trap 180mm
[Icons: Flush, Dual Inlet, S-trap, P-trap, WELS 4 stars]

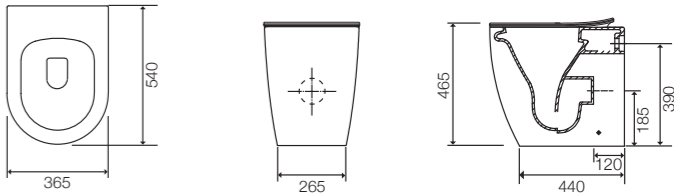

Wall hung pan with slim line seat
SY04331
WELS 4 stars | 4.5 / 3L
[Icons: Flush, Dual Inlet, S-trap, P-trap, WELS 4 stars]

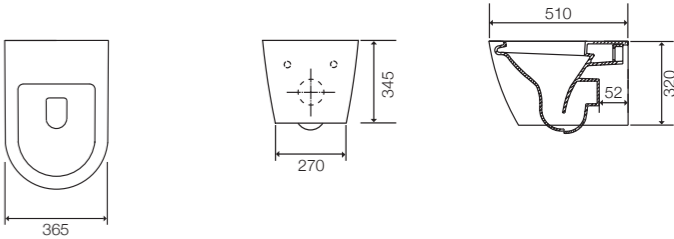

Solid surface bath with
overflow
Matte white finish
SY31221 - 1700 x 800mm
Capacity: 305L | Weight: 139kg
SY31222 - 1500 x 750mm
Capacity: 270L | Weight: 120kg
Also available with matte
black exterior

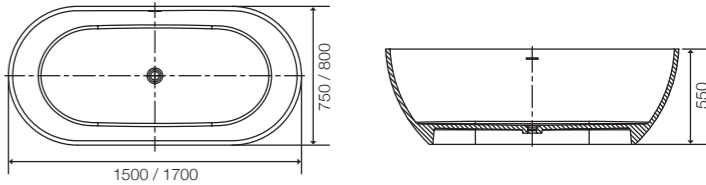

Above counter mounted,
thin rimmed ceramic basin
SY04612 - 375 x 375mm
SY04615 - 470 x 375mm

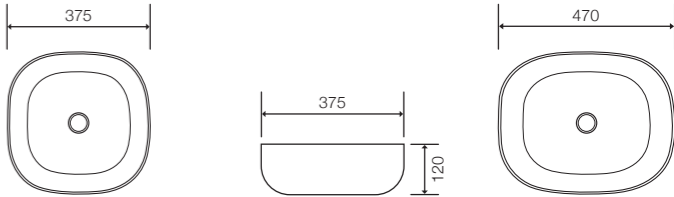



Streamline Products Pty Ltd

21 Compark Circuit, MULGRAVE, Victoria 3170

Ph: 1300 735 352 | customerservice@streamlineproducts.com.au

www.streamlineproducts.com.au