

Axis tubular handshower on fixed wall bracket

AX02430

WELS: 3 star

Litre/min: 8.5L

WELS License / Reg No: 1483 / S12926

Handshower: Single settings

Finishes available:

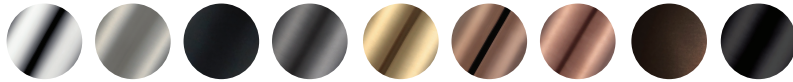

Chrome Brushed Nickel[^] (.SN) Matte Black (.MB) Brushed Gun Metal[^] (.GM) Brushed Brass[^] (.BB) Rose Gold[^] (.RG) Brushed Rose Gold[^] (.RGI) Dark Bronze[^] (.DB) Brushed Iron[^] (.BI)

[^] PVD finish



INFORMATION

Pressure Rating
150 - 500kPa

Hot and cold water inlet pressures
should be equal.

CARE AND MAINTENANCE

- All surfaces should be frequent cleaned with a mixture of mild, pH neutral soap and warm water with a soft cloth
- Do not use abrasive clothes, scouring pads on surfaces
- Do not use harsh cleaning agents i.e. cream cleaners or citrus based cleaners (*see cleaning leaflet for comprehensive list*)

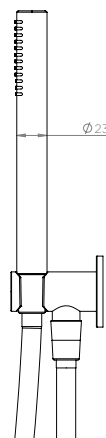
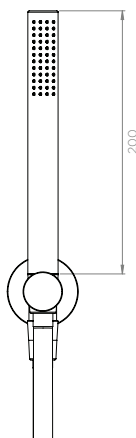
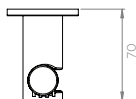

WARRANTY
15 years

*Conditions apply.

stream|line

Dimensions are in millimeters and are subject to manufacturing variations. Streamline Products reserves the right to vary specifications at any time without notice. Information provided within this specification sheet is correct at the date of printing. Please confirm all particulars with your sales consultant prior to purchase. Version: 1.1 - April 2025