

## Eneo 500 x 400 Above Counter Basin

ENO4694

**Tap hole(s):** n/a

**Overflow:** No

**Waste assembly supplied:** No

**Finish:** Solid Surface

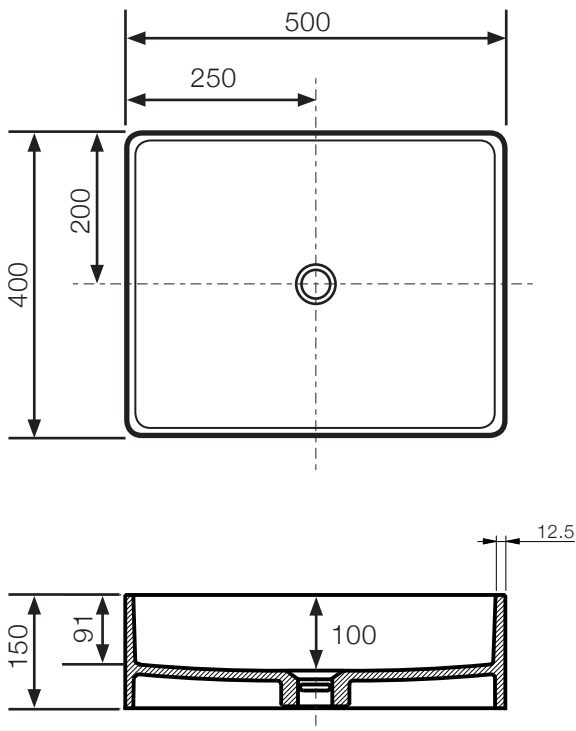

Solid surface is a non-porous, homogeneous surfacing material which consists of Acrylic Resin (also known as PMMA) and Aluminum TriHydrate (ATH).

- Non-porous
- Stain resistant
- Repairable and renewable: Cuts and scratches can be buffed out with a Scotch-Brite pad or orbital sander.
- Heat resistance: the material is heat resistant up to 100°C, but can be damaged by excess heat above these levels.