

## SynergiiOne Back Inlet Toilet Suite

SY04137 & SY04147

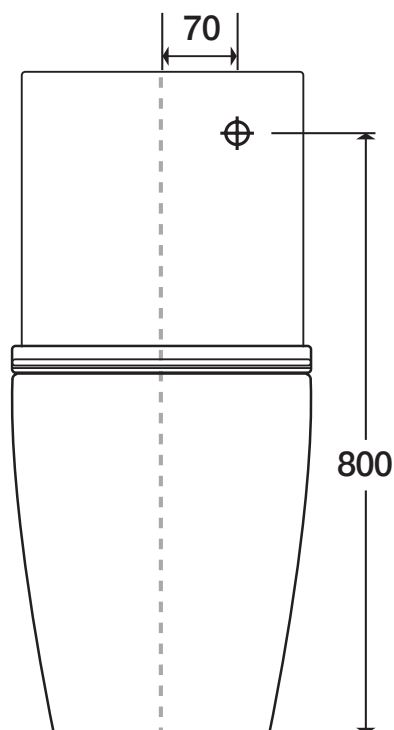

Front view

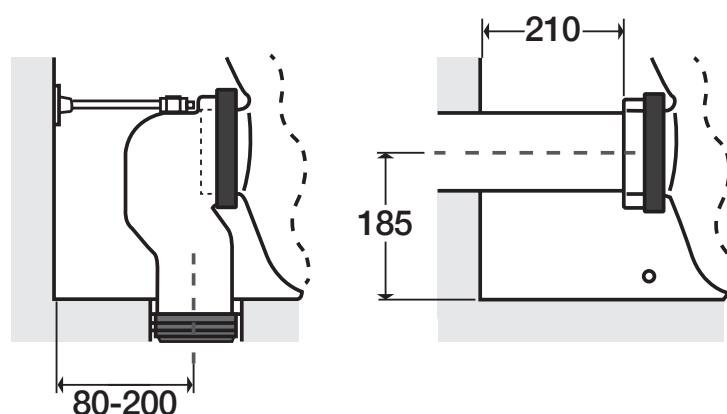

*Optional elbow for set out 160-220mm (JT34)*

This SynergiiOne Back Inlet Toilet Suite is designed for right hand inlet installation. A 1/2" male thread will need to be plumbed in at the location shown.

The standard set-out for a S-Trap is 80-200mm.

All distances are from final floor or finished wall.

**The installer will need to supply the right angle stop tap.**

Please leave the instructions with the owner.



1

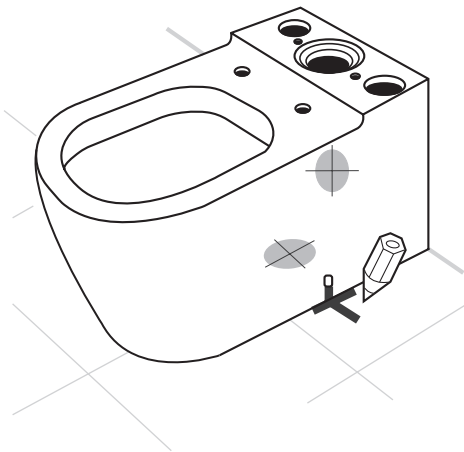

Place the pan in position ensuring it is centred in accordance with the centre line of the outlet. Mark location of pan fixing bolts.

2

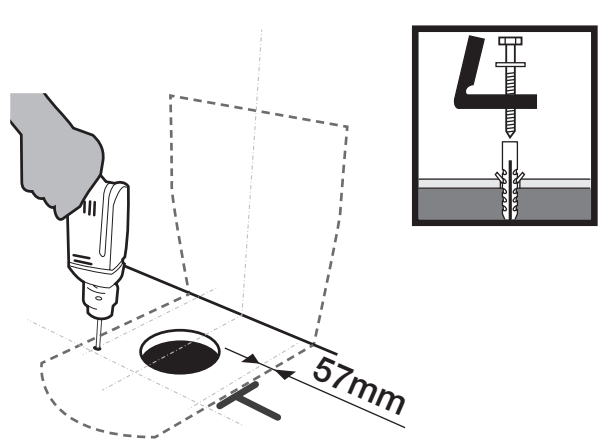

Remove pan, drill holes for fixing bolts and attach brackets.

3

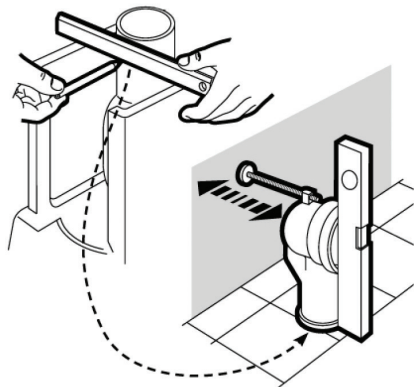

For **S Trap installation**, cut horizontal pipe to required length and fit seal. Attach wall fixing kit to elbow, push elbow into the pan collar and adjust to correct height. Fix to wall and adjust to ensure the elbow is vertical.

4

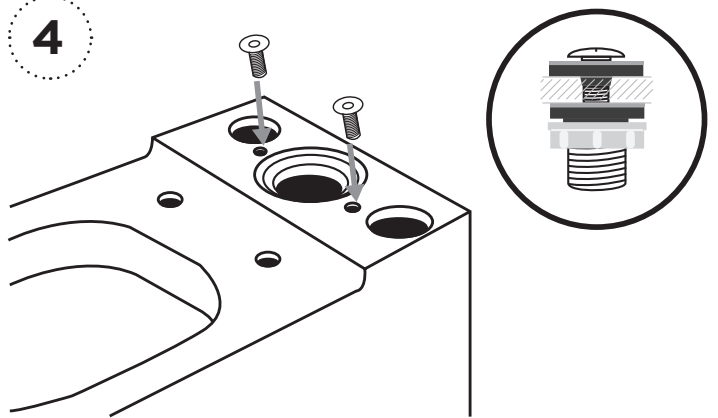

Attach pan bolts, into holes, as shown.

5

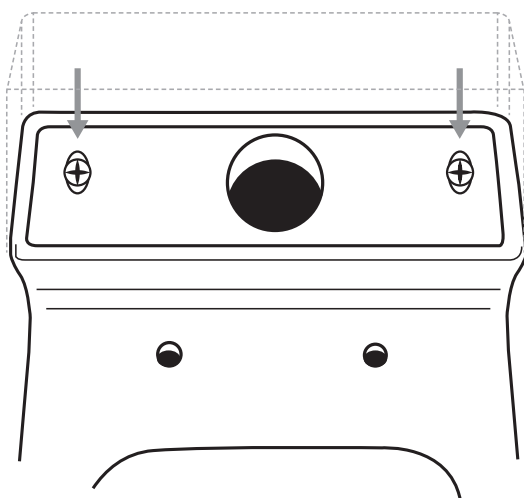

Ensure pan bolts are positioned so the plastic cistern is flat against the wall when screwed down.

6

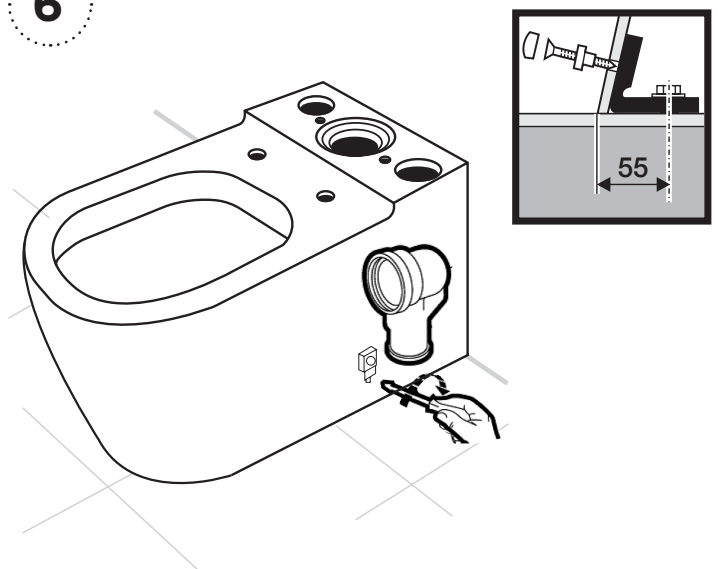

Locate the pan in the final position. Screw threads into floor mount brackets.

7

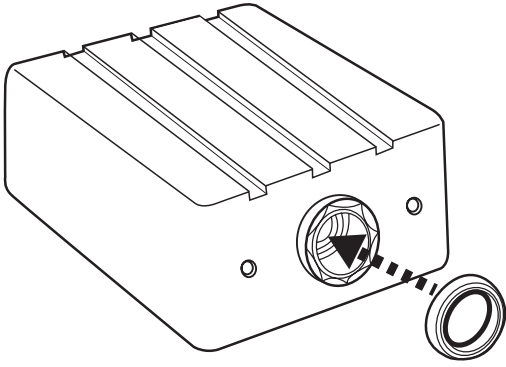

Fit outlet seal to bottom of outlet mechanism. **Do not place outlet seal on pan and then sit cistern on top!**

9

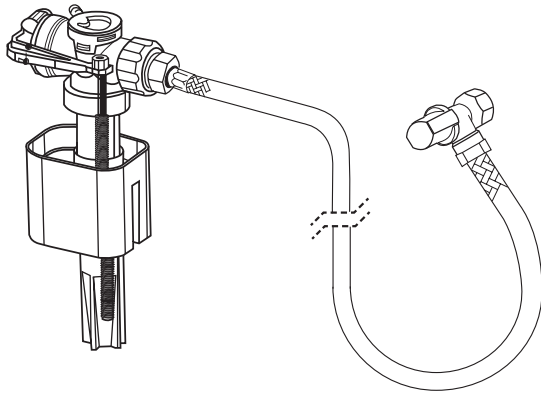

Screw inlet hose onto stop tap. Place inlet valve into position within the cistern.

8

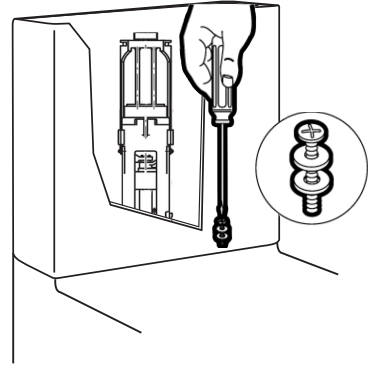

Remove inlet mechanism. Locate the cistern onto the pan. Screw down **by hand until tight** to ensure a seal between the bolt head and the bottom of the cistern. The cistern should sit flush against the wall.

10

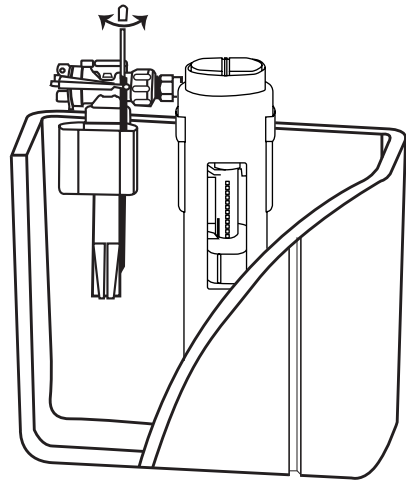

Check if the inlet valve is under normal operation and adjust the inlet valve float adjustment thumbscrew clockwise (for higher float & water level) or anticlockwise (for lower float & water level).

11

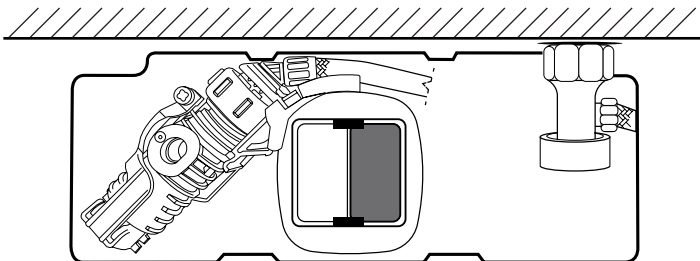

Before proceeding, ensure that all valves are configured as per diagram above.

12

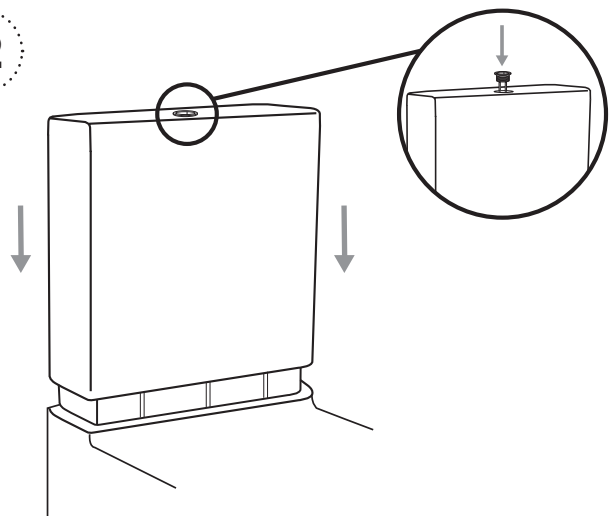

Screw button set onto ceramic cistern cover. Ensure the half and full flush is lined up correctly with the correct positions on the outlet valve.

Slide ceramic cistern cover over the plastic cistern, ensuring that the grooves on cover and plastic cistern line up. This will ensure the cover sits securely.

13

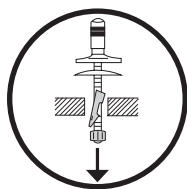
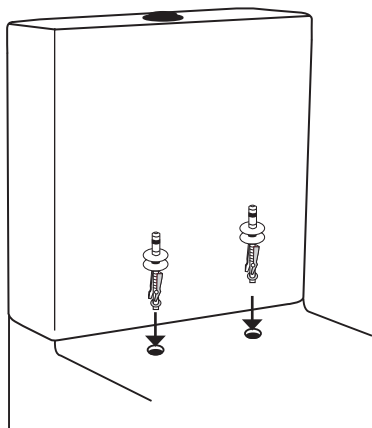

Seat Install: Insert fixing bolts into holes in the pan.

14

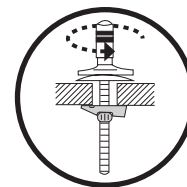
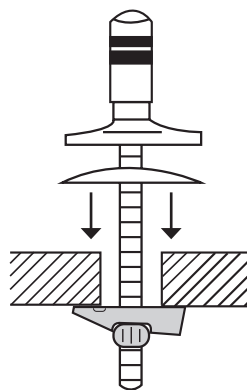

Push the plastic and metal washers as far down the screw as possible, then finger tighten.

15

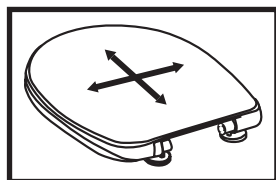
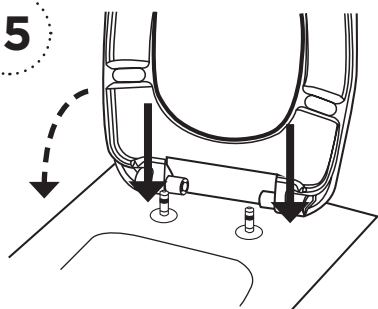

Push seat onto the posts and close lid. Move the seat around until it is square with the pan.

16

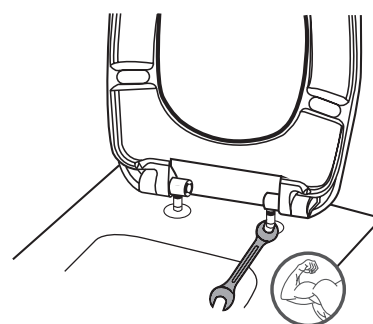

Once you have positioned the seat in the desired position, open the lid and with an **8mm spanner**, tighten the posts until the seat is locked in place.

Please leave the instructions with the owner.

stream|ine

ARCISAN

Technical and Service - Ph: 1300 735 352 | Email: support@streamlineproducts.com.au