



## AXUS PIN FREESTANDING BATH MIXERS

### AX01340 | AX01345

#### INSTALLATION AND CARE INSTRUCTIONS

##### IMPORTANT INFORMATION

- Hot and cold water inlet pressures should be equal.
- Operating static pressure is 150—500kpa. If pressure exceeds this, then an approved pressure limiting valve must be fitted.
- Pipework must be flushed out prior to installation of the mixer. Damage caused to the mixer by debris coming through the pipework is not covered under warranty.
- Any flow controller incorporated in the outlet to be tightened to prevent removal by hand.
- Installation shall comply with AS/NZS3500.1, AS/NS3500.4 or the relevant local requirements.
- Maximum hot water temperature is 75°C.
- Not suitable for gravity feed applications.

# CONTENTS

---

2	Cleaning, care and maintenance instructions
3	Exploded view / parts list
4	Brass base installation methods
	Residential
	Commercial
9	Installation instructions
12	Warranty

## Cleaning, care and maintenance instructions

---

Frequent cleaning of your Arcisan product is recommended to help combat the build up of grime and dirt on surfaces that can damage and reduce the life of your product.

To keep your Arcisan product in good condition, it is highly recommend that it be wiped with a soft sponge or cloth, after each use, to remove any residual water spots.

For a more thorough clean, a mixture of mild, pH neutral soap and warm water with the use of a soft cloth, is all that is required to wipe down your product.

**DO NOT** use harsh cleaning agents that contain caustics, abrasives, citrus acids, bleach, vinegar, ammonia, peroxides or alcohol/ethanol based ingredients on your product.

**DO NOT** use abrasive cloths, scouring pads etc on surfaces as it will become damaged.

Always protect surfaces against cologne and nail polish removers.

Make sure you carefully read all instructions and ingredients in cleaners before applying to your product.

### NOTE!!

All warranties are void if inappropriate cleaners and cloths are used on Arcisan products and if fittings are not kept clean.

# Exploded view / Parts list

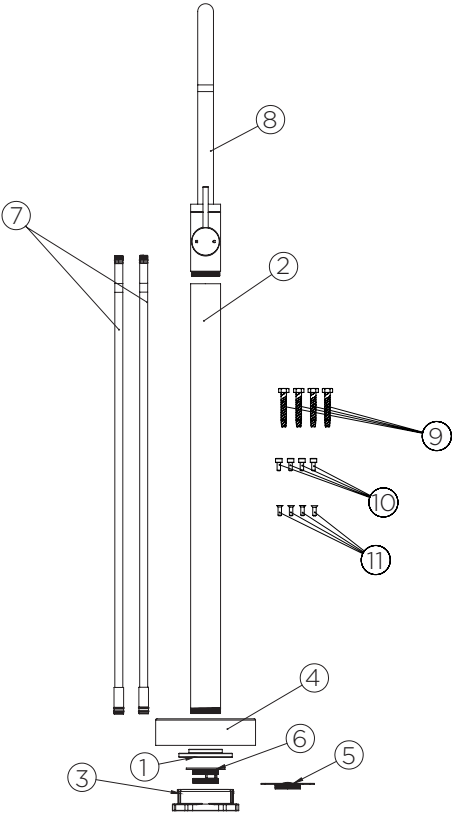

Item No.	Description	Qty
1	Slotted connection plate	1
2	Outer tube	1
3	Brass base plate	1
4	Base cover	1
5	Levelling plate with bullseye level	1
6	Brass insert	1
7	Copper water pipes	2
8	Mixer assembly	1
9	M8 concrete screw - 50mm long	4
10	M5 caphead screw - 15mm long	4
11	M5 countersink screw - 15mm long	4

# BRASS BASE INSTALLATION METHODS

## RESIDENTIAL - TIMBER FLOOR

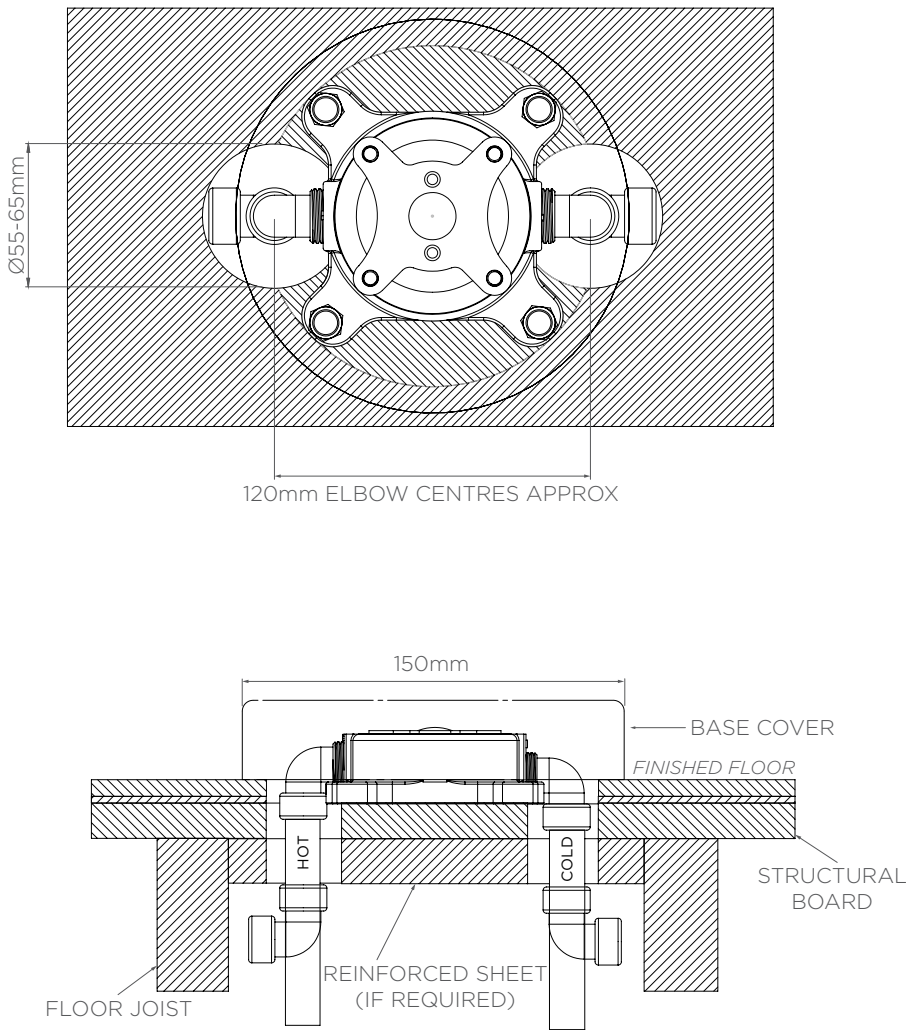

# BRASS BASE INSTALLATION METHODS

## RESIDENTIAL - CONCRETE SLAB

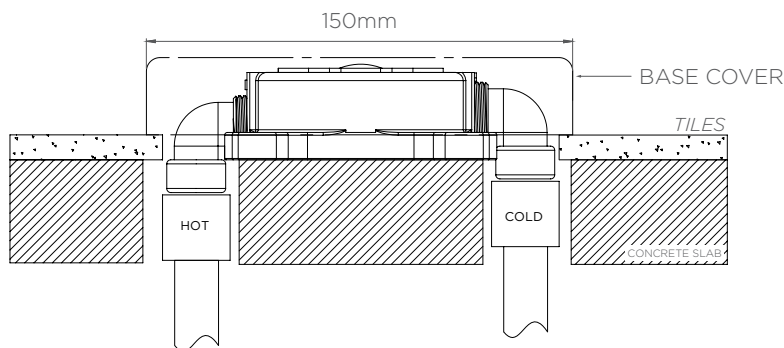
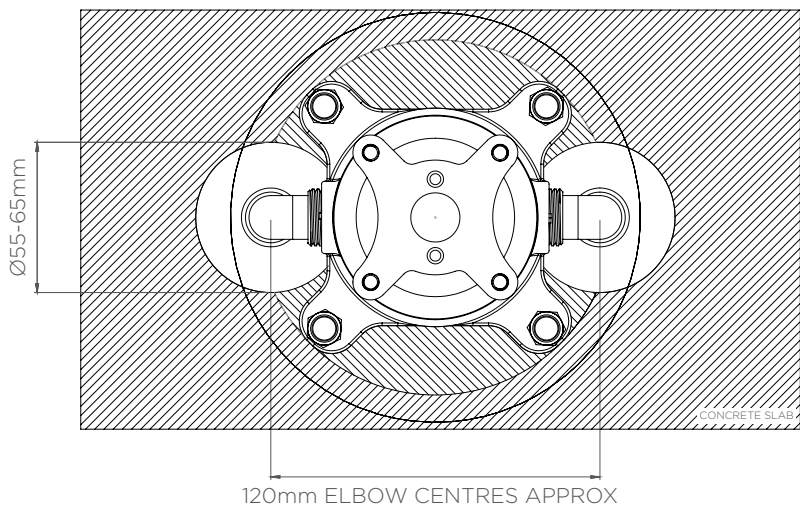

# BRASS BASE INSTALLATION METHODS

## COMMERCIAL - CONCRETE SLAB - TOP MOUNT

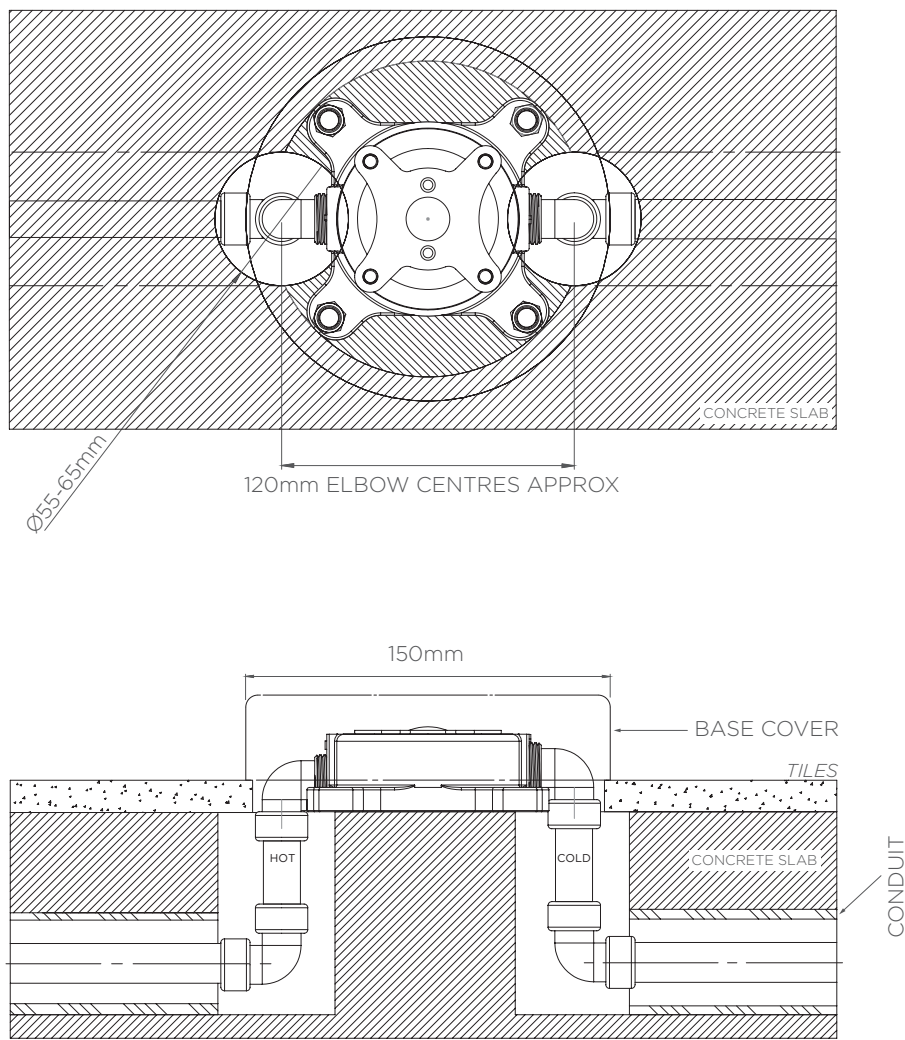

# BRASS BASE INSTALLATION METHODS

## COMMERCIAL - CONCRETE SLAB - IN-FLOOR MOUNT

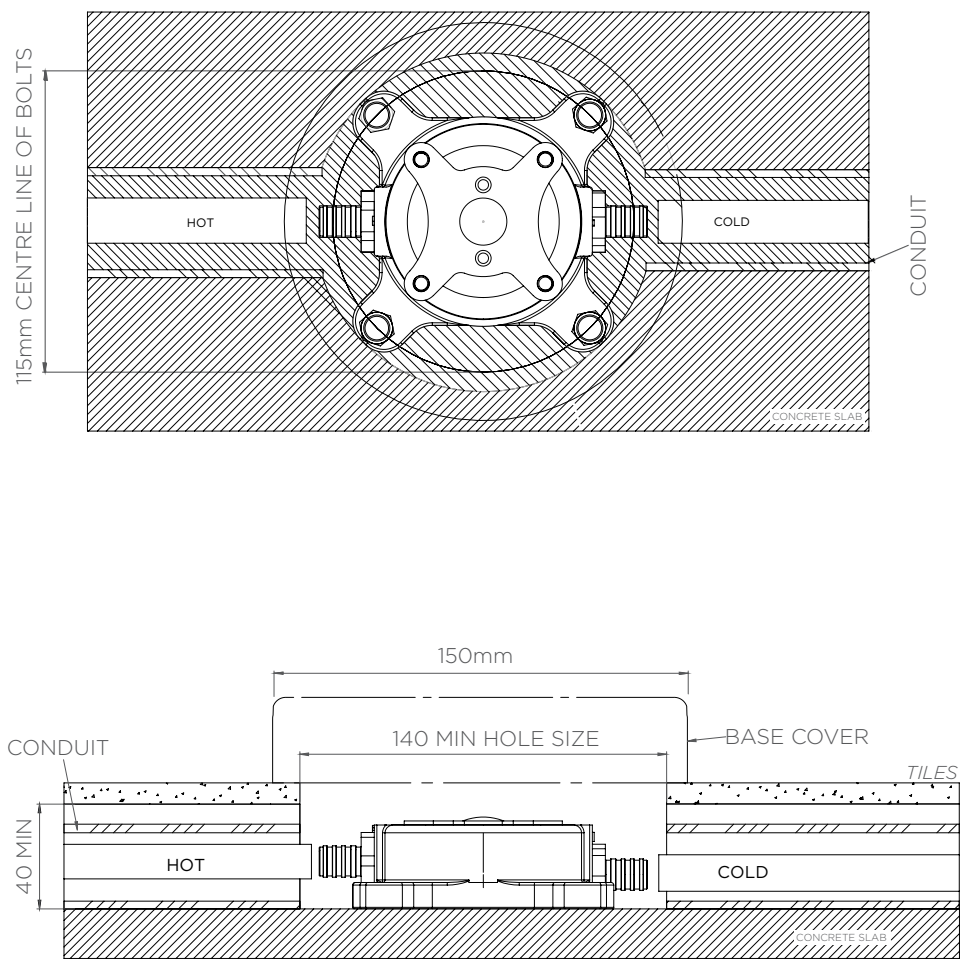

# BRASS BASE INSTALLATION METHODS

COMMERCIAL - CONCRETE SLAB - 45° ENTRY

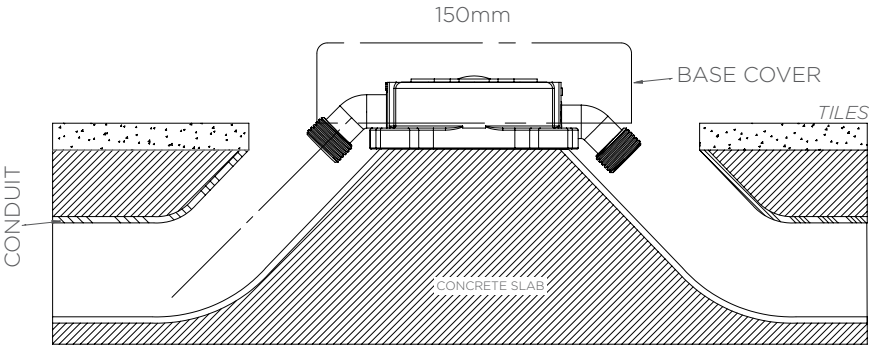
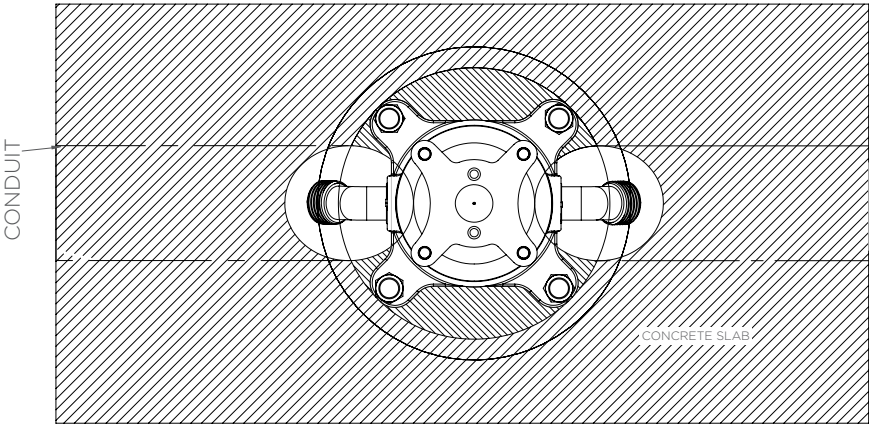



# INSTALLATION INSTRUCTIONS

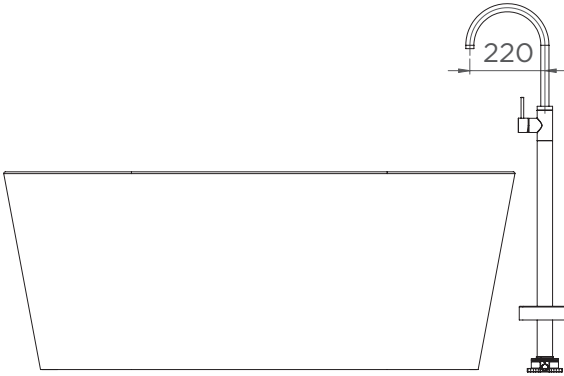

## PREPARATION

Ensure that the base of freestanding mixer is located at appropriate distance to the bath.

Levelling plate

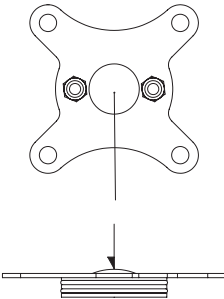

1. Bolt levelling plate onto brass base plate, using M5 caphead screws provided, before starting.

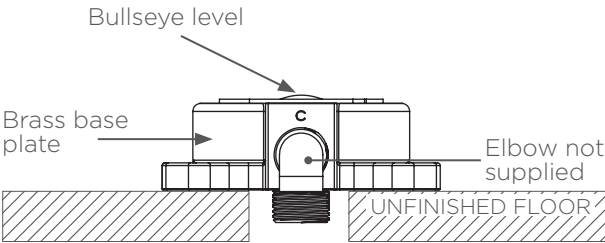

2. Use the four dynabolts or wood screws, to mount brass base plate to unfinished floor.

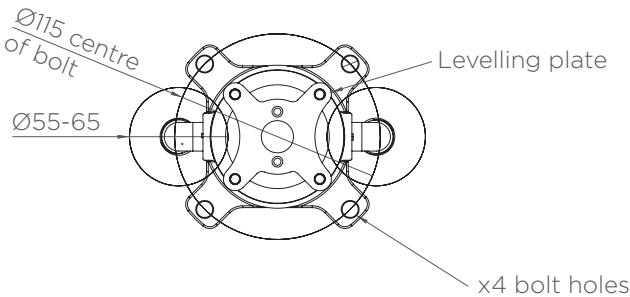

# INSTALLATION INSTRUCTIONS

---

3. Ensure that brass base plate is level by checking bullseye level.

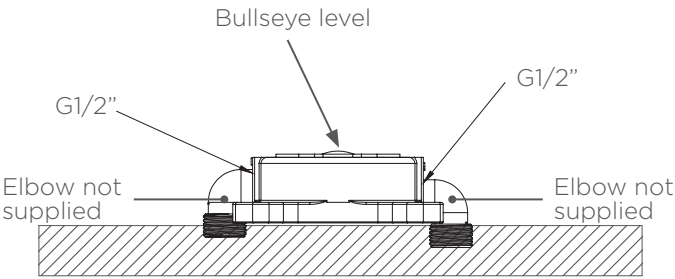

4. Slide base cover carefully over end of outer tube whilst ensuring it does not scratch.

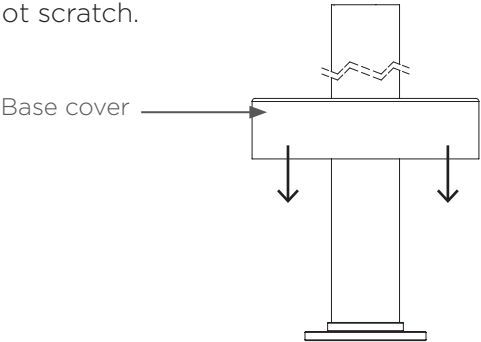

5. Fit the hot and cold copper pipes firmly into the mixer body, then screw on outer tube to mixer body.

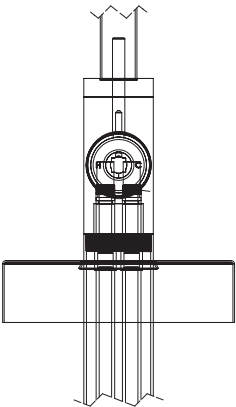

# INSTALLATION INSTRUCTIONS

6. Align hot and cold copper pipes to correct holes on brass insert and push on. Mount brass insert to slotted connection plate with counter sunk screws.

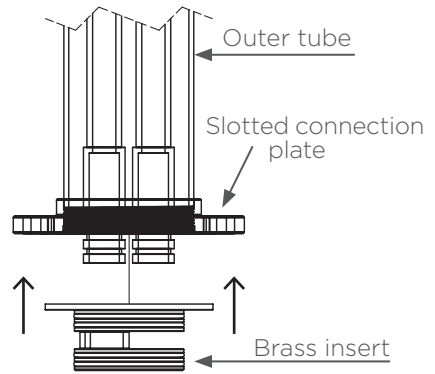

**BEFORE PROCEEDING TURN OFF WATER AND REMOVE LEVELLING PLATE FROM BRASS BASE PLATE**

7. Push on mixer assembly with outer tube into brass base plate.

Rotate mixer so it faces bath.

Bolt the slotted flange to brass base plate using caphead screws provided.

Push down base cover until it rests on floor.

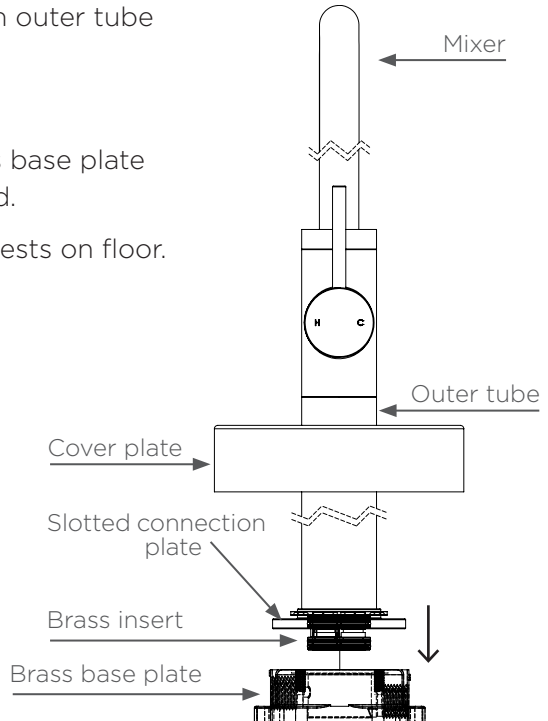

# WARRANTY

---

## Guarantee

Arcisan mixers are covered by a 15 year conditional residential warranty subject to the terms below.

- > 15 year cartridge replacement warranty against the ceramic disc cartridge leaking—parts only.
- > 7 year product or parts warranty against manufacturing defects. (Hoses and hand sprays on kitchen mixers are 2 years).
- > 1 year replacement product or parts and labour warranty.

Streamline reserves the right to assess, fix, replace or service warranty claims as they see fit. The warranty period applies from date of purchase or date of handover for new buildings. If this is not available, the manufacturing date stamp on the product will be used.

Warranty claims should first be directed through the point of purchase. It is mandatory that the purchaser provide proof of purchase and the warranty is valid for the original purchaser only and is not transferable.

## Exclusions

The warranty does not apply to the following cases:

- Blocked or damaged aerators are not covered under the warranty. Other damage caused by not flushing the system before connection or use.
- Damage caused by improper installation, abuse, accident and misuse. Also previous repair or alteration without the company's or agent's permission.
- Warranty only applies to items purchased through an authorised re-seller within Australia.
- Tapware used in a commercial setting. This is subject to a 1 year parts and labour warranty.
- General wear and tear from normal use of the product, including scratching from cleaning.
- Water temperature or pressure exceeds the stated maximums. The maximum water pressure is 500kpa and maximum temperature is 75 degrees Celsius.

## Consequential Damages

Streamline Products will not be liable for damage to other items (floor coverings, walls, lights and other fittings) or any other type of consequential losses caused by a defect in the product, except when the failure amounts to a major failure under your statutory rights.

## Statutory Rights

Our goods come with guarantees that cannot be excluded in the Australian Consumer Law. You are entitled to a replacement or refund for a major failure and for compensation for any other reasonably foreseeable loss or damage. You are also entitled to have the goods repaired or replaced if the goods fail to be of acceptable quality and the failure does not amount to a major failure.

## Contact

This warranty is provided by Streamline Products P/L

Phone: 1300 735 352

Email: [customerservice@streamlineproducts.com.au](mailto:customerservice@streamlineproducts.com.au)