

ARCISAN Kasta-Lux F.I.C above counter 520x320mm ribbed basin with pop-up waste

KL776940

Weight: 13.5kg

Tap hole(s): No

Overflow: No

Waste assembly supplied: Yes

Finishes available:



Charcoal
(.CL)



Earth
(.EA)



Olive
(.OL)



White
Stone
(.WS)
pictured

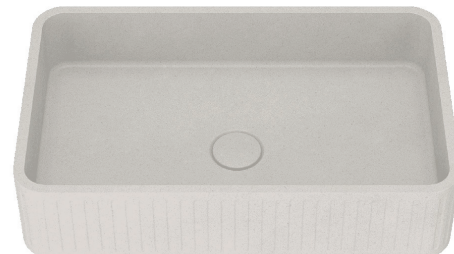

IMPORTANT

This basin is a new material which is a hybrid between traditional concrete basins and solid surface. Please be aware your basin may have more or less texture than pictured here.

CARE AND MAINTENANCE

- All surfaces should be frequent cleaned with a mixture of mild, pH neutral soap and warm water with a soft cloth
- Do not use abrasive clothes, scouring pads on surfaces
- Do not use harsh cleaning agents i.e. cream cleaners or citrus based cleaners (see cleaning leaflet supplied with basin for comprehensive list)

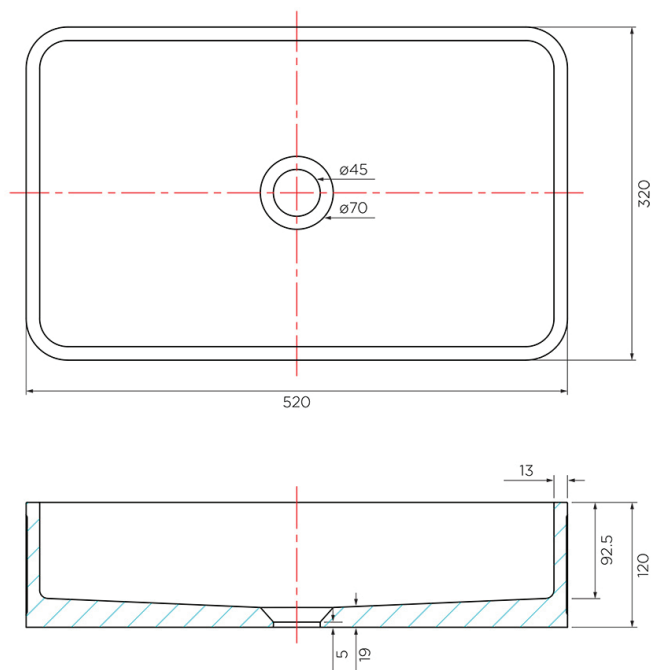

WARRANTY
10 year

*Against manufacturers defects

streamline

Dimensions are in millimeters and are subject to manufacturing variations. Streamline Products reserves the right to vary specifications at any time without notice. Information provided within this specification sheet is correct at the date of printing. Please confirm all particulars with your sales consultant prior to purchase. Version: 1.0 - Jan 2024